



- * **LOW STORAGE COSTS BECAUSE OF ONLY ONE PROGRAMMABLE VERSION**
- * **QUICK CONFIGURATION WITH SET-UP CONNECTOR**
- * **HIGH FLEXIBILITY AND SIMPLE START-UP BY WAY OF PC-PROGRAMMABILITY**
- * **2-WIRE TECHNOLOGY, 4-20 MA**
- * **HIGH ACCURACY**

OPERATION AND SYSTEM CONSTRUCTION

Electronic measurement and conversion of RTD-input signal in industrial temperature measurement. The online configuration using PC with the configuration kit TZ 41 can be done during the measurement with the Set-up connector. The temperature head transmitter converts the RTD-signal into a scalable 4-20 mA analogue output signal.

TECHNICAL DATA

power supply	8...35 V DC, polarity protected
input current required	≤ 3,5 mA
current limit	≤ 23,0 mA
switch on delay	4 s
response time	2 s
failure signal	≤ 3,6 mA ≥ 21,0 mA can be set up
influence of power supply	≤ +/-0,01%/ V / 24
connection type	2-wire technology
output signal	4-20 mA analogue or 20-4 mA
max. load	(V _{ref} -10V) / 0,022 A
long term stability	≤ ± 0,1 K / year
load influence	≤ ± 0,02 % / 100 Ω

temperature drift	0,01 % / K
calibration temperature	23 °C ± 5 K
configurable range	< 50% range
run up time of the connection	DIN / EN
ambient temperature	-40...+85°C
climatic class	class C, EN60654-1
moisture condensation	allowable
galvanic isolation	no
weight	40 g
protection class	IP66/IP00
vibration protection	4g / 2... 150 HZ
CE conformity	EN 61326-1

MEASURING RANGE

type	range	min. range	accuracy
Pt 100	-200 - 650 °C (-328 - 1202 ° F)	10 K	0,2 K or 0,08 %
IEC 751	-50 - 250 °C (-58 - 482 ° F)	10 K	0,1 K or 0,08 %
- input: 2-, 3- or 4-wire - 2-wire: cable resistance compensation possible			
All data refer to the measuring range			

Digital temperature transmitter - Type TE 42 -

CONFIGURABLE PARAMETER

Connection type / sensor, dimension (° C / ° F), range, cable resistance compensation, failure signal, output signal, offset, TAG / 8 signs), output simulation

electrical connection

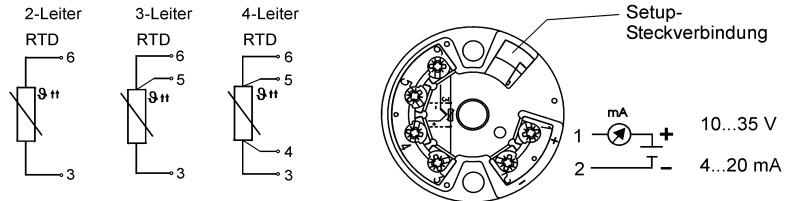

construction

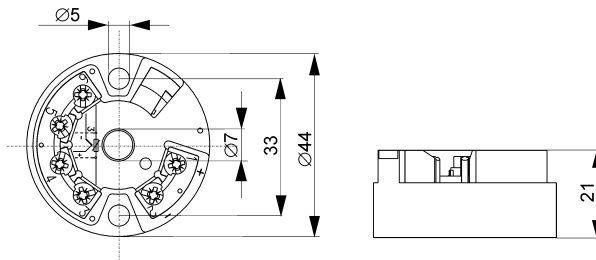

ORDER DETAILS

option	
0	standard
galvanic isolation	
0	w/o galvanic Isolation
configuration (by PC)	
0	without preadjustment
1	with preadjustment
factory configuration	
1	Pt 100
linearisation	
1	with linearisation
input	
1	input Pt 100 2-wire (please fill in line resistance)
2	input Pt 100 3-wire
3	Input Pt 100 4-wire
output	
1	4 - 20 mA
2	20 - 4 mA
error message	
29	< 3,6 mA (Namur)
39	> 21,0 mA (Namur)
accessories	
programming software / hardware TZ 41 / 42	

TE 42	0	0		1	1			
-------	---	---	--	---	---	--	--	--

Our products are constantly in further development, therefore subjects to modifications.