

Conductive level sensor - Type NKS11 -

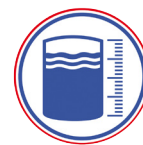

FEATURES

- CONDUCTIVE THRESHOLD LEVEL DETECTION OF LIQUID MEDIA
- VERSION SUITABLE FOR HIGH-HYGIENE ENVIRONMENTS EHEDG / FDA
- STAINLESS STEEL HOUSING IP67
- MAINTENANCE-FREE
- WITH NM OR NCI LEVEL MODULE OR BLOCK TERMINAL

DESCRIPTION

The conductive level sensors are mainly used to detect limit threshold levels in liquids such as fruit juices, beer, milk, etc. with a minimum conductivity of 5 μ S.

The favourable design, with its sealing cone and the corresponding welding sockets, means that there are no places in which residues can collect. The sensor is therefore easy to clean and suitable for use in the food and pharmaceutical industry etc. CIP- and SIP-suitability are guaranteed.

The non-corrosive materials used for the rod and insulation mean that the sensor is also suitable for corrosive media. Various process connection forms render optimal adaptation to the application possible. The sensor can be shortened, which has a positive and practical effect on storage. The electrode is coated with HALAR, which means that the threshold level detection is also suitable for foaming media.

TECHNICAL DATA

Conditions of use	
Type of protection	IP 67 acc. EN 60529
Operating temperature	max. 140 °C
Environmental temperature	-10...+60 °C
Operating pressure	P _{max} = 6bar
Construction	
Electrode length	200, 500, 800, 1500 mm, can be shortened, other lengths on request
Electrical connection	- cable gland M16x1.5 - bipolar terminal (2.5 mm ²) - optional: M12x1 connection plug
Process connection	standard NKS 11: G ½ B threaded connection, 1.4571 / metal seal, torque: approx. 15 Nm optional NKS 13: G ¾ B with union nut and O-ring for welding socket, G ¾, l= 1500 mm, d= 11 mm
Insulation	PEEK (FDA-approved)
Sensor rod	stainless steel 1.4571, \varnothing 4 mm
Coating	ECTFE (HALAR), \varnothing 0.7 mm, FDA approved
Installation instructions	
- the maximum permissible torque (15 Nm) must be taken into account when fitting the sensor - the tank or pipe wall must be made of metal - when installing the sensor, only use the key surface, not the connection head - the process connection thread of the sensor must have free electrical contact to the wall of the pipe/tank (do not use any insulating sealing materials !)	

Conductive level sensor - Type NKS11 -

DIMENSIONAL DRAWINGS (dimensions in mm)

Electrical connection:

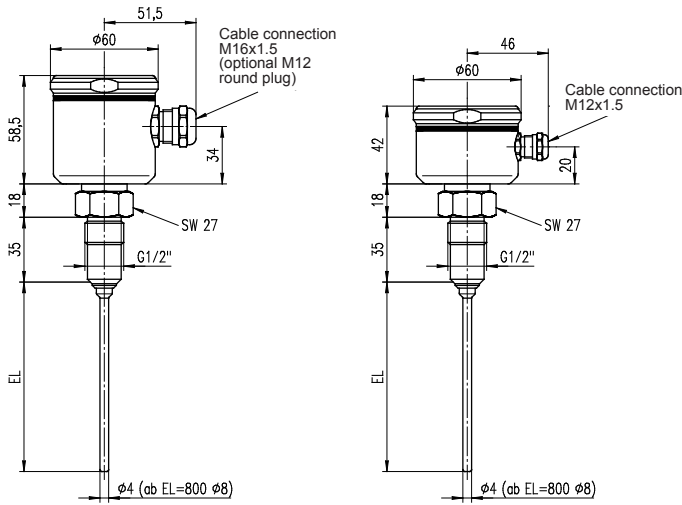

NKS11 ... NM (NC1)

NKS11 ... 00

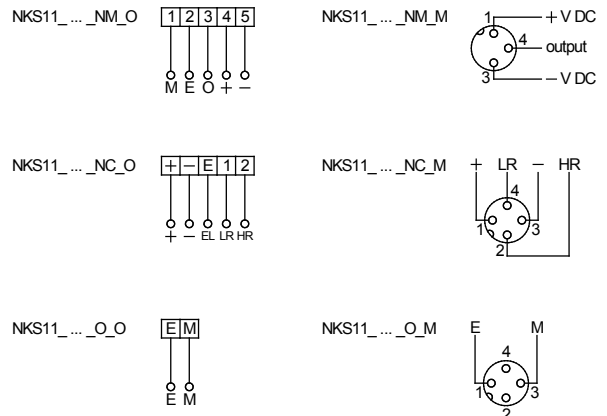

Prozessanschlussadapter: (weitere Ausführungen auf Anfrage)
adapters for process-connection: (other constructions on request)

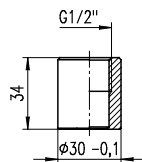

TEM1FTP16
Einschweißmuffe
welded socket

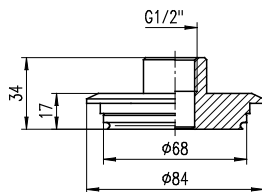

TVA6FTP16
VARIVENT-Flansch Ø68
VARIVENT-flange Ø68

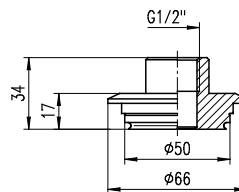

TVA5FTP16
VARIVENT-Flansch Ø50
VARIVENT-flange Ø50

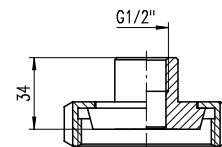

TMN...FTP16
Kegelstutzen DIN 11851
conical nozzle DIN 11851
DN25, DN40, DN50

ORDERING INFORMATION for NKS11

Sensor length / coated

0010	0	10mm without coating, Ø=4mm
0200		200mm, Ø=4mm
0500		500mm, Ø=4mm
0800		800mm, Ø=8mm
1000		1000mm, Ø=8mm
1500		1500mm, Ø=8mm
	0	without coating
	1	with coating

Output / electronics

O	Terminal
NM	Level module NM - full / empty switchable, adjustable sensitivity, output 50mA
NC	Level module NC1 - self-adjusting, for foam detection, 2 switching outlets full / empty

Electrical connection

O	Cable connection M16x1,5 (M12x1,5 bei Ausführung mit Klemme)
M	M12x1 plug

NKS11

--	--	--

Please observe the permissible nominal pressure of the process connection selected.
All specifications and certifications specified are only guaranteed when Hengesbach original components are used.
Our devices are subject to constant development; subject to technical modification.